



TRUCK MIXER DRIVES

500 Series

PRODUCT FEATURES

- Suitable for truck mixers in a range from 1 to 12 cubic meters.
- Torque rating from 3000 Nm to 75000 Nm.
- 2 or 3-stage planetary reductions.
- Main bearing allows for chassis bending during travelling.
Max tilting angle, in all directions is 4.5° or 6°, depending on model.
- High axial and radial load capacity.
- Suitable for both low speed and high speed hydraulic motors.
- Larger mixer drives can be provided with:
 - Water pump P.T.O.,
 - Speed sensor.



| Type | Max. torque Nm | Ratios 1: | Hydraulic motor drive (1) | Max. input speed min ⁻¹ | Drum capacity (2) | Weight Kg | Oil quantity l | Design | Water pump P.T.O. | Speed sensor |
|------|-------------------|---------------|------------------------------|---------------------------------------|----------------------|--------------|-------------------|--------|-------------------|--------------|
| 501 | 3000 | 17-23-29 | LS | 550 | 0,5 - 1 | 45 | 1.5 | A | – | – |
| 564 | 12000 | 78-161 | HS | 2500 | 2 - 3 | 85 | 2 | A | – | – |
| 565 | 12000 | 22 | LS | 550 | 2 - 3 | 70 | 1.5 | A | – | – |
| 567 | 20000 | 76-90-115-128 | HS | 2500 | 4 - 5 | 140 | 3 | A | – | – |
| 568 | 20000 | 18-21-27 | LS | 550 | 4 - 5 | 130 | 2.5 | A | – | – |
| 575 | 50000 | 100 | HS | 3000 | 6 - 9 | 250 | 8 | B | • | • |
| 580 | 75000 | 130-147 | HS | 3000 | 9 - 12 | 320 | 10 | B | • | • |

(1) LS = Low speed motor, HS = High speed motor

(2) General indication, application capacity depend on concrete slump

– = Not available

• = Available

DESIGN A

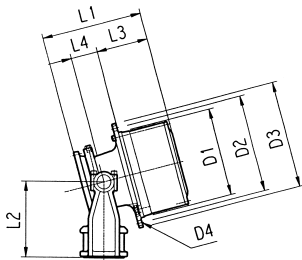

DESIGN B

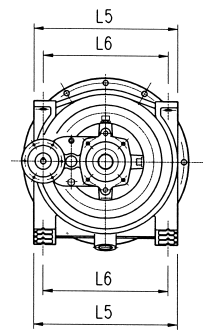
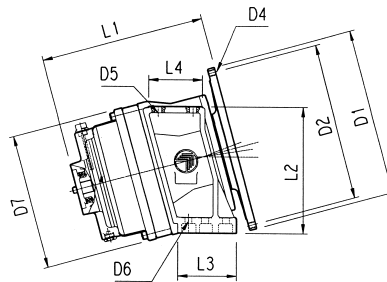

| Type | Dimensions | | | | | | | | | | | | |
|------|------------|-----|-----|----------|---------|---------|-----|-----|-----|-----|-----|-----|-----|
| | D1 | D2 | D3 | D4 | D5 | D6 | D7 | L1 | L2 | L3 | L4 | L5 | L6 |
| 501 | 200 | 222 | 245 | 13 N° 4 | | | | 270 | 195 | 138 | 89 | | |
| 564 | 280 | 310 | 340 | 17 N° 10 | | | | 365 | 240 | 165 | 85 | | |
| 565 | 280 | 310 | 340 | 17 N° 10 | | | | 290 | 240 | 165 | 85 | | |
| 567 | 358 | 390 | 430 | 17 N° 18 | | | | 435 | 300 | 210 | 110 | | |
| 568 | 358 | 390 | 430 | 17 N° 18 | | | | 360 | 300 | 210 | 110 | | |
| 575 | 530 | 500 | | 17 N° 24 | 22 N° 4 | 22 N° 6 | | 450 | 400 | 188 | 170 | 460 | 400 |
| 580 | 530 | 500 | | 17 N° 24 | 22 N° 4 | 22 N° 6 | 430 | 525 | 400 | 188 | 170 | 460 | 400 |